



# Stafford

CRANE GROUP



## CH2000\_3260



196.9 ft/min



656.2 ft



7055lb



31



SNL

# CH2000 3260

Phoenix Hoist by Elevek

Complies with

EN 12159  
&  
ANSI A10.4

## Characteristics

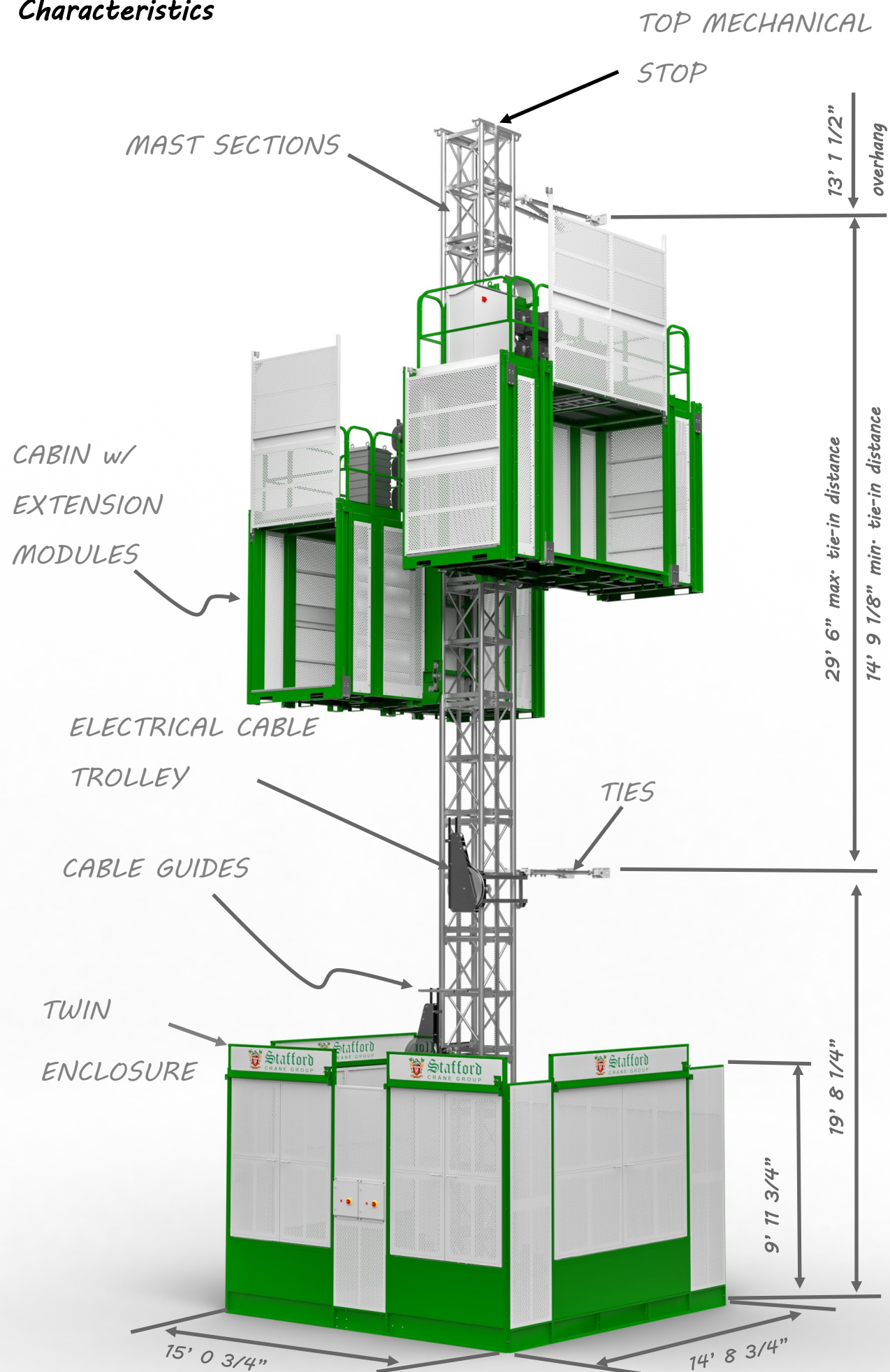

*Access doors:*

- Single vertical sliding door
- Double vertical sliding door
- Folding access ramp with railing

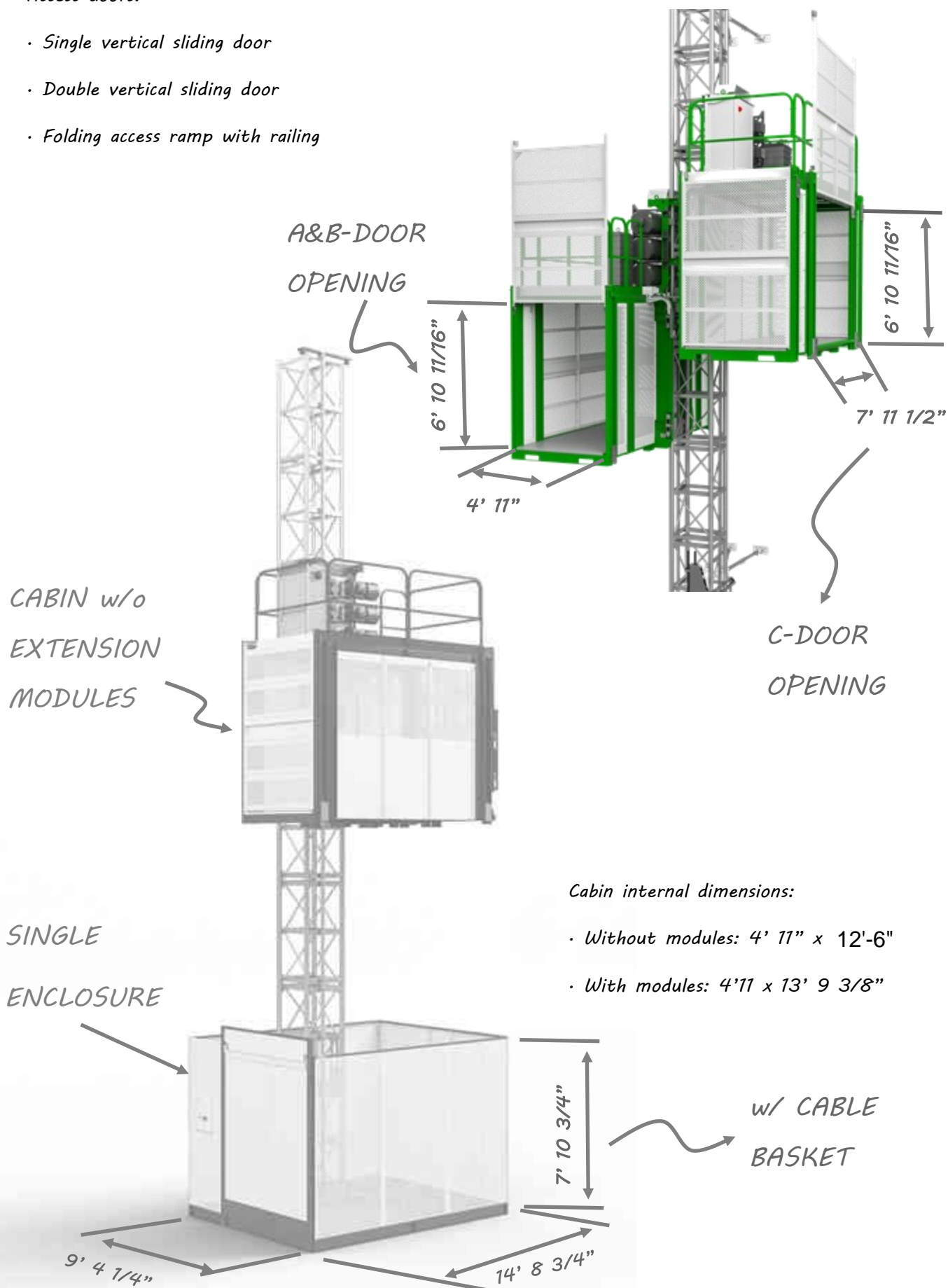

*Cabin internal dimensions:*

- Without modules: 4' 11" x 12'-6"
- With modules: 4' 11" x 13' 9 3/8"



# Foundation

Minimum soil bearing  
required 1044 psf

Concrete RC-25  
(3626 psi) @ 28  
days

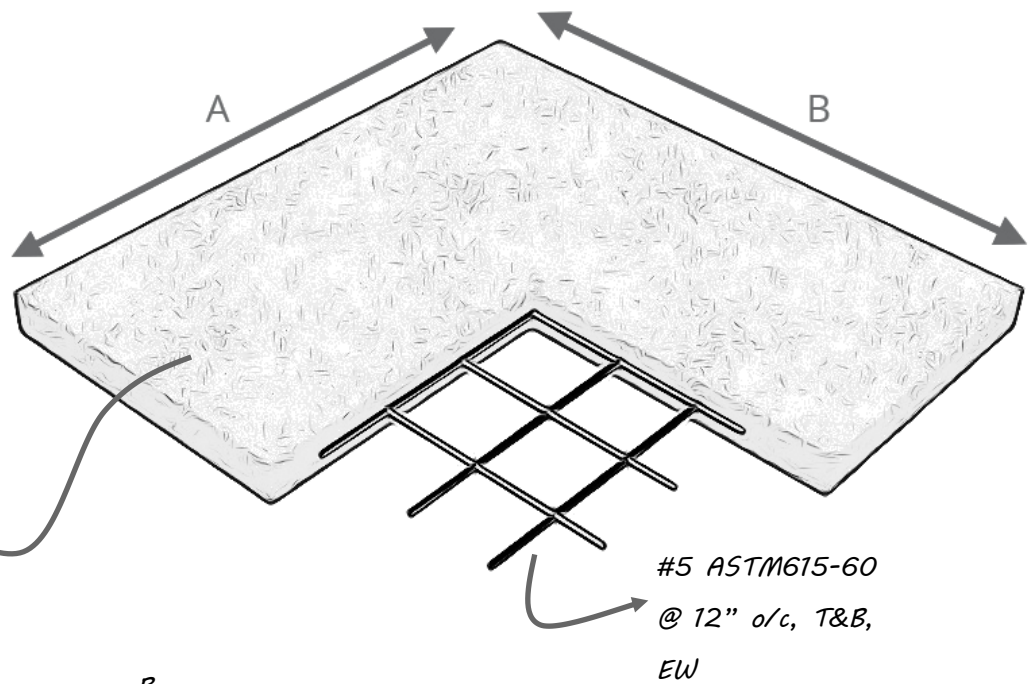

	A	B
TWIN	15' 9"	16' 1"
SINGLE	15' 9"	10' 4"

Anchor bolts by  
STAFFORD

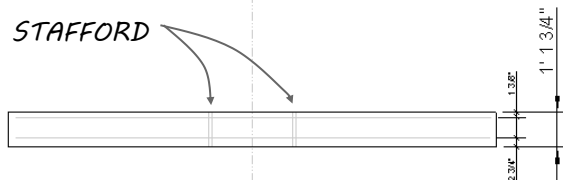

Building side

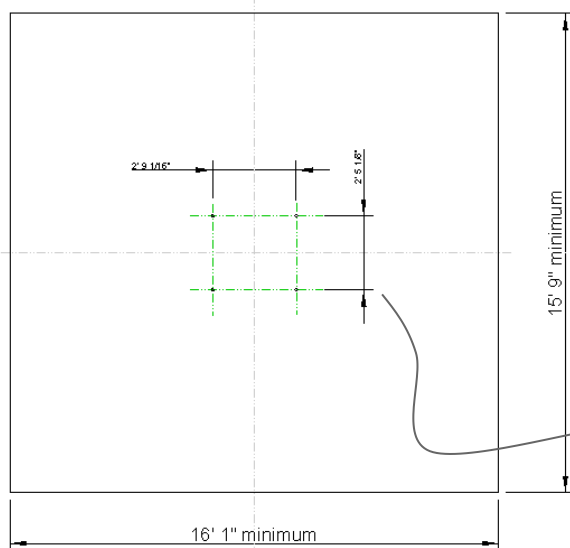

**IMPORTANT!!**

Verify that the use of a slab  
foundation conforms to all appli-  
cable federal, state and local  
standards and codes prior to  
foundation installation.

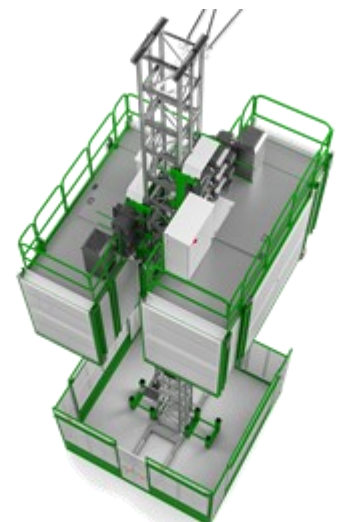

*Points to be considered:*

- *Distance from building to the center of the mast section will depend on the tie installed*
- *Characteristics of the foundation based on a max. 490ft mast height*
- *For specific information, attachment points, ties, etc. contact Stafford*
- *Final drawings will be reviewed by Stafford, Engineering, Contractor before any installation*
- *Check and verify the Manufacturer's manual before any procedure*
- *Alternative installations contact Stafford*

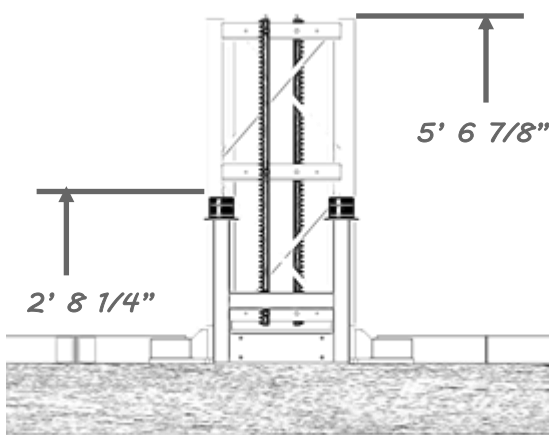

- 1) Reinforced concrete foundation
- 2) Buffer kit
- 3) MAst section
- 4) Base frame arms
- 5) Base frame

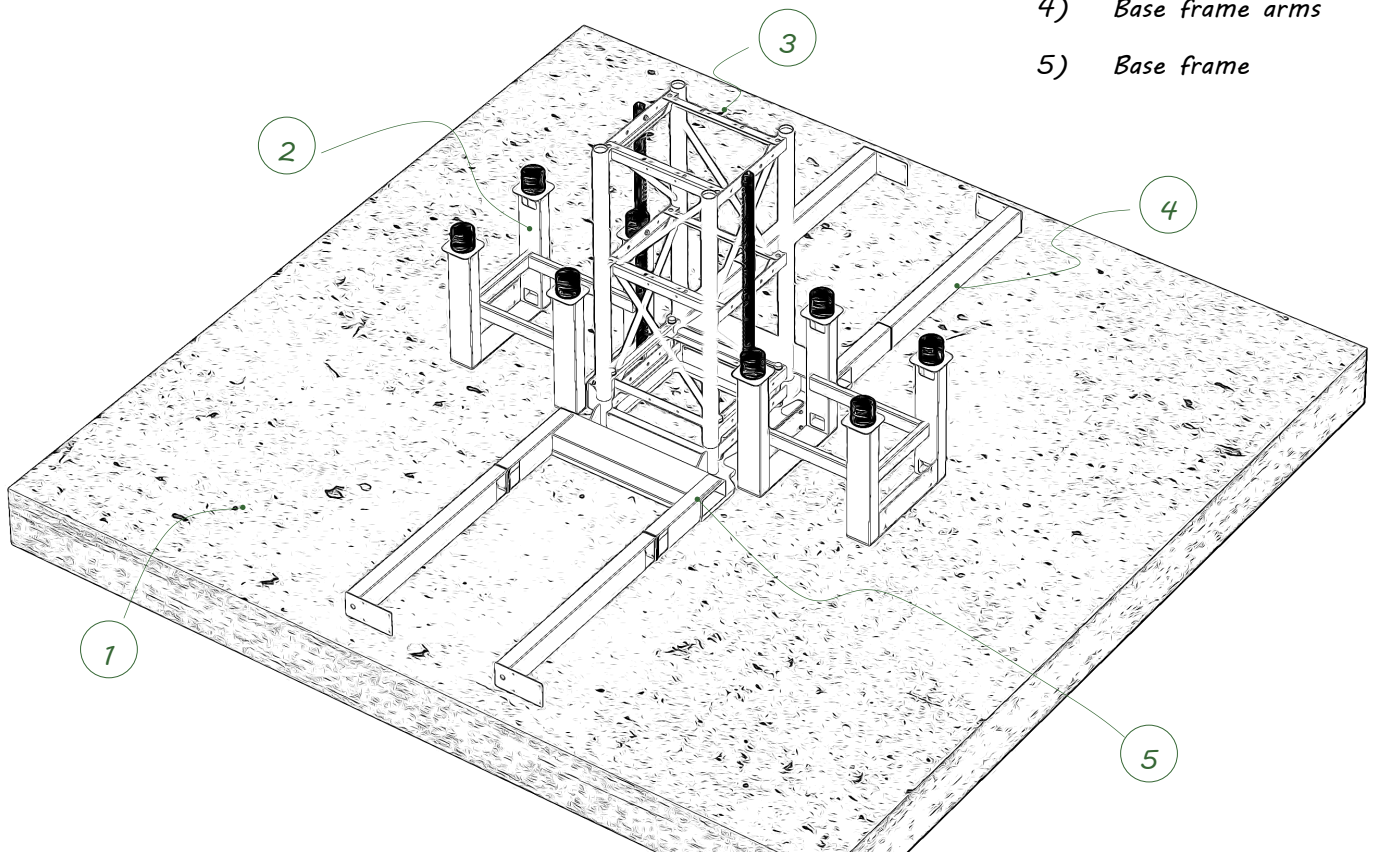

# Ties

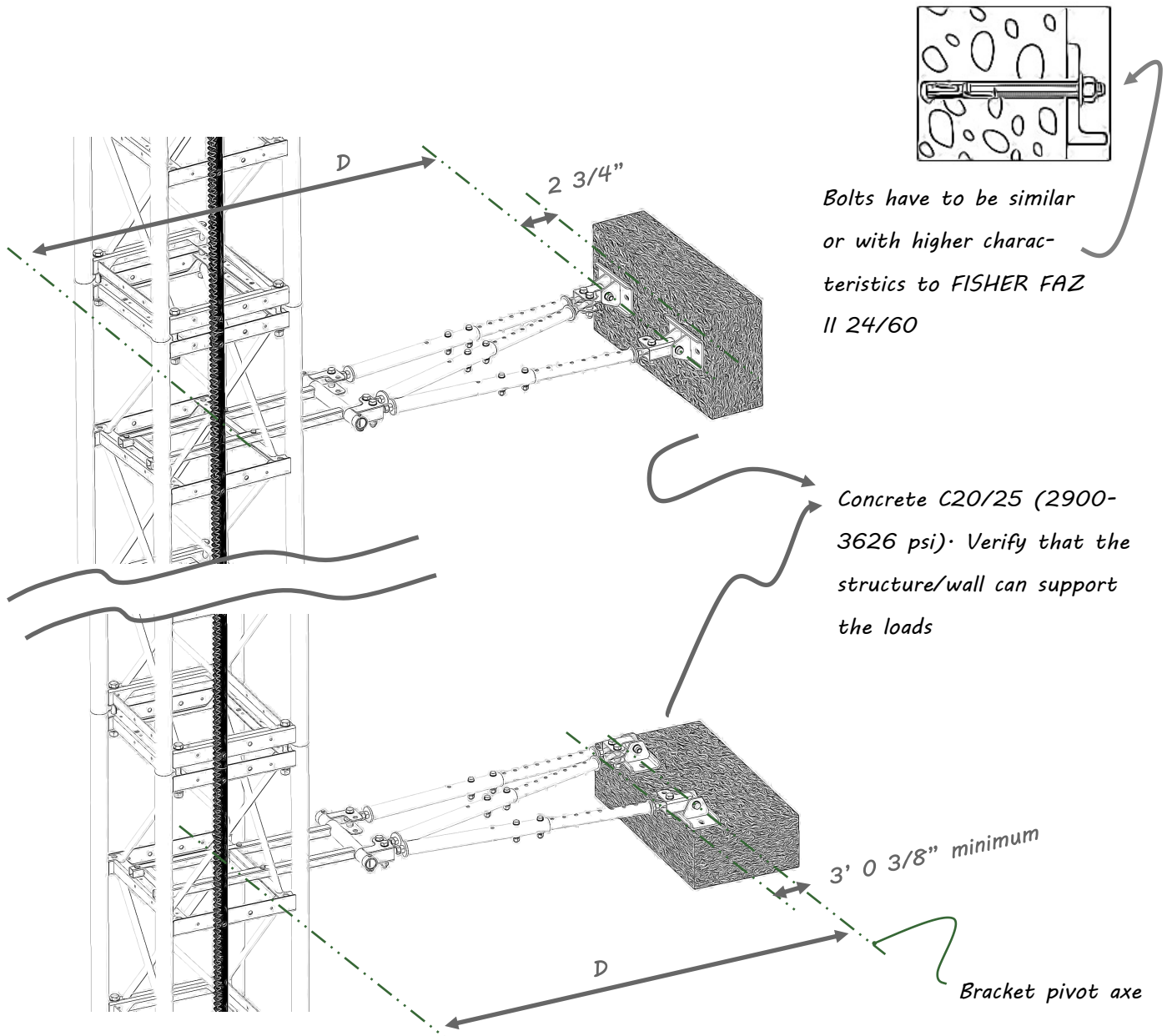

Length of the ties from the center of the mast section to the bracket pivot axe:

$D \rightarrow$  Adjustable from 5' 7" to 7' 10 1/2"

Points to be considered:

- Ties can be installed  $\pm 8^\circ$  from the horizontal
- Tie brackets can be fixed to the wall or to a slab, take care of the fixing point load capacity
- For single car installation other type of ties are available

## IMPORTANT!!

Bolts to fix the ties to the structure or the wall must comply with the local codes.

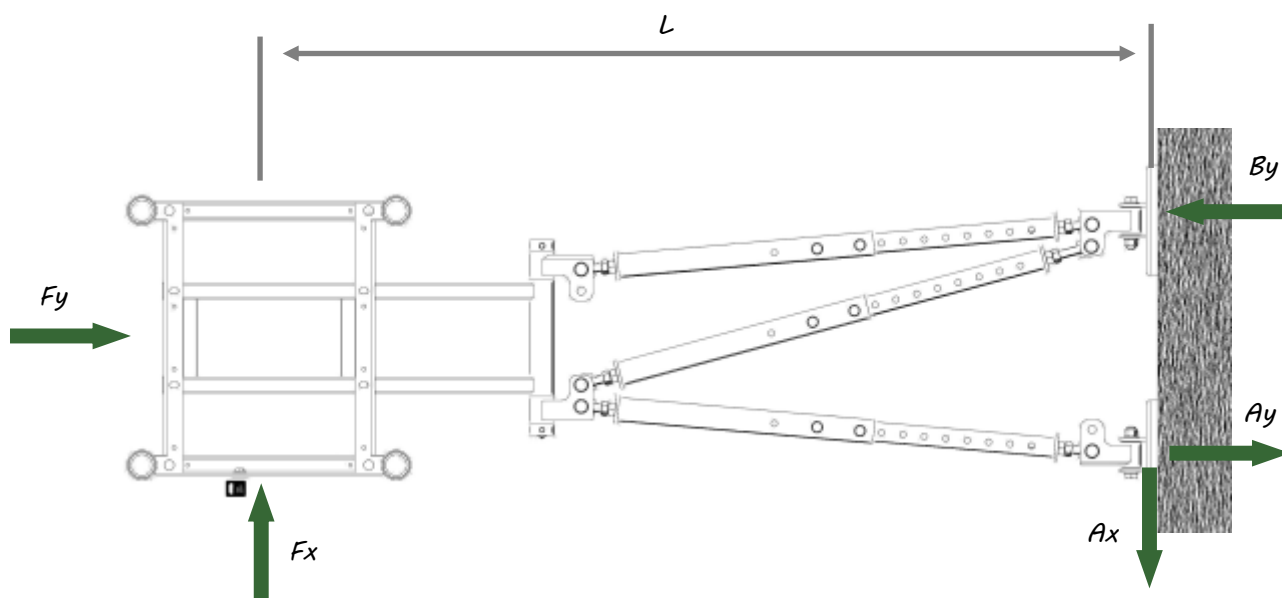

## SINGLE CONFIGURATION

	$A_x$	$A_y$	$B_y$
$L_{min} : 5' 7''$	5620 lbf	8770 lbf	8770 lbf
$L_{mx} : 7' 10 \frac{1}{2}''$	5620 lbf	12365 lbf	12365 lbf

## TWIN CONFIGURATION

	$A_x$	$A_y$	$B_y$
$L_{min} : 5' 7''$	5620 lbf	17535 lbf	17535 lbf
$L_{mx} : 7' 10 \frac{1}{2}''$	5620 lbf	24500 lbf	24500 lbf

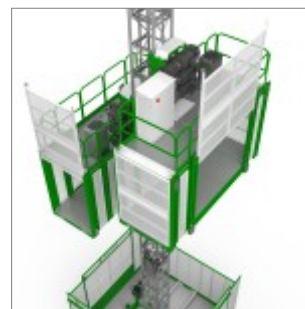



**IMPORTANT!!**

ANSI A10.4 11.3 specifies a  
1/2" (min.) to 2 1/2" (max.)  
clearance between car platform  
sill and landing sill.

**IMPORTANT!!**

Verify before installing to assure  
compliance with applicable stan-  
dards, codes and regulations.

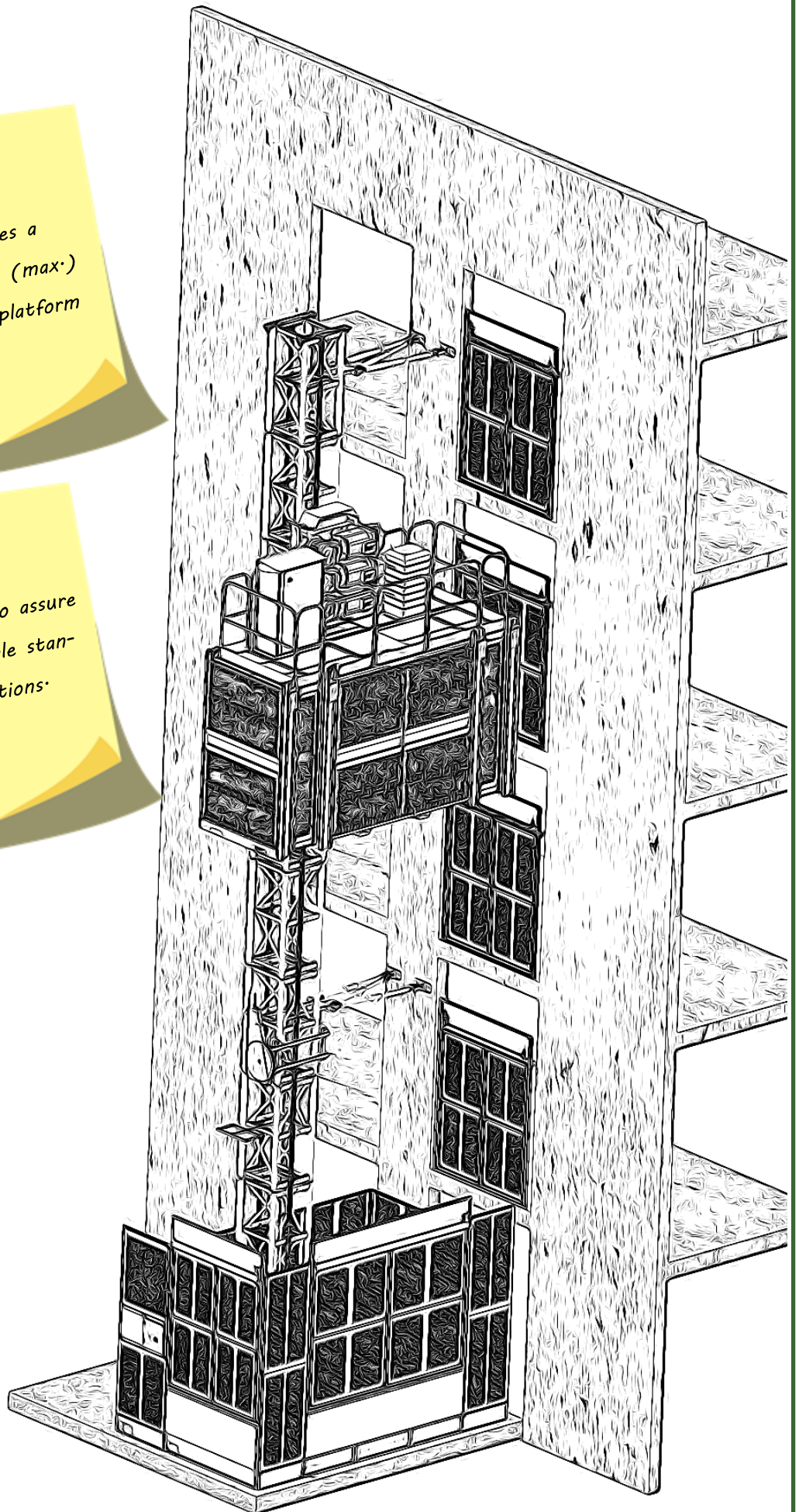

# Technical specification

**CH2000\_3260**

Load capacity	7055 lb
Rated speed	196.9 ft/min
Maximum height	656.2 ft (*)
Min-max tie-in distance	14' 9 1/8" - 29' 6"
Mast section	4.9 ft x 2,382 ft x 2.382 ft - 286.6 lb
Rack module	8
Number of motors	3
Power	18,5 kW
Power supply	480V 3P+PE 60Hz
Control voltage	48 V
Amperage	125 A

(\*) For higher values contact us

## Features

- 3 Geared motor brakes per drive unit
- Buffers at the travel limits
- Non-slip floor
- Over-speed safety device
- Cabin access doors with electromechanical interlock
- Emergency exit at the cabin roof
- Overload device
- Cabin roof railing
- Rack inductive detector
- Frequency inverter
- Modular car
- Emergency stop
- Low voltage panel
- Enclosure
- Travel limit switches and emergency l.s.
- Phase control relay
- Cable trolley

## Optionals

- Test control box
- Landing control box
- Jib and hoist
- Maintenance control box
- Cable basket
- Grease applicator
- Assembly platform with l.s.
- Lateral side door
- Landing gates with limit switch
- Hoistway protections
- Ramp at the landing exit
- C-door



### STAFFORD CRANE GROUP

3620 S. 40th Street,  
Phoenix, AZ, 85040 USA  
T +1 4809933302 | F +1 6029268886

[sales@staffordcranegroup.com](mailto:sales@staffordcranegroup.com) [www.staffordcranegroup.com](http://www.staffordcranegroup.com)



### CICLO FAPRIL, S.A.

Rua do Vale do Grou, nº 1378, Apt. 2  
3754-908 Aguada da Cima, Águeda | PORTUGAL  
T +351 234 660 570 | F +351 234 666 030

[elevek@elevek.com](mailto:elevek@elevek.com) | [www.elevak.com](http://www.elevak.com)